



P.O. BOX 180
VULCAN, ALBERTA
T0L 2B0

TELEPHONE: 1-403-485-2241
TOLL FREE: 1-877-485-2299
FAX: 1-403-485-2920
www.vulcancounty.ab.ca

May 7, 2026

Our File: DP 21-2026

Notification of Proposed Development

Vulcan County has received a development permit application:

Location: Division 2; Plan 2211160, Block 1, Lot 1 in SW 17-18-25 W4
Development: Moved-in Dwelling
Land Use District: (GCR) – Grouped Country Residential
Applicant: **William and Leslie Hall**

This application is due for consideration by Vulcan County Administration on **May 21, 2026**.

If you have any concerns or comments regarding this development or if you require more information, please contact the Vulcan County office, quoting the above file number by **4:00 pm on May 20, 2026**, to the Development Department via regular mail, fax, email devassist@vulcancounty.ab.ca, or call 403-485-3135.

Kindest Regards,

A handwritten signature in blue ink that reads "Alena Matlock".

Alena Matlock
Development Officer
Vulcan County

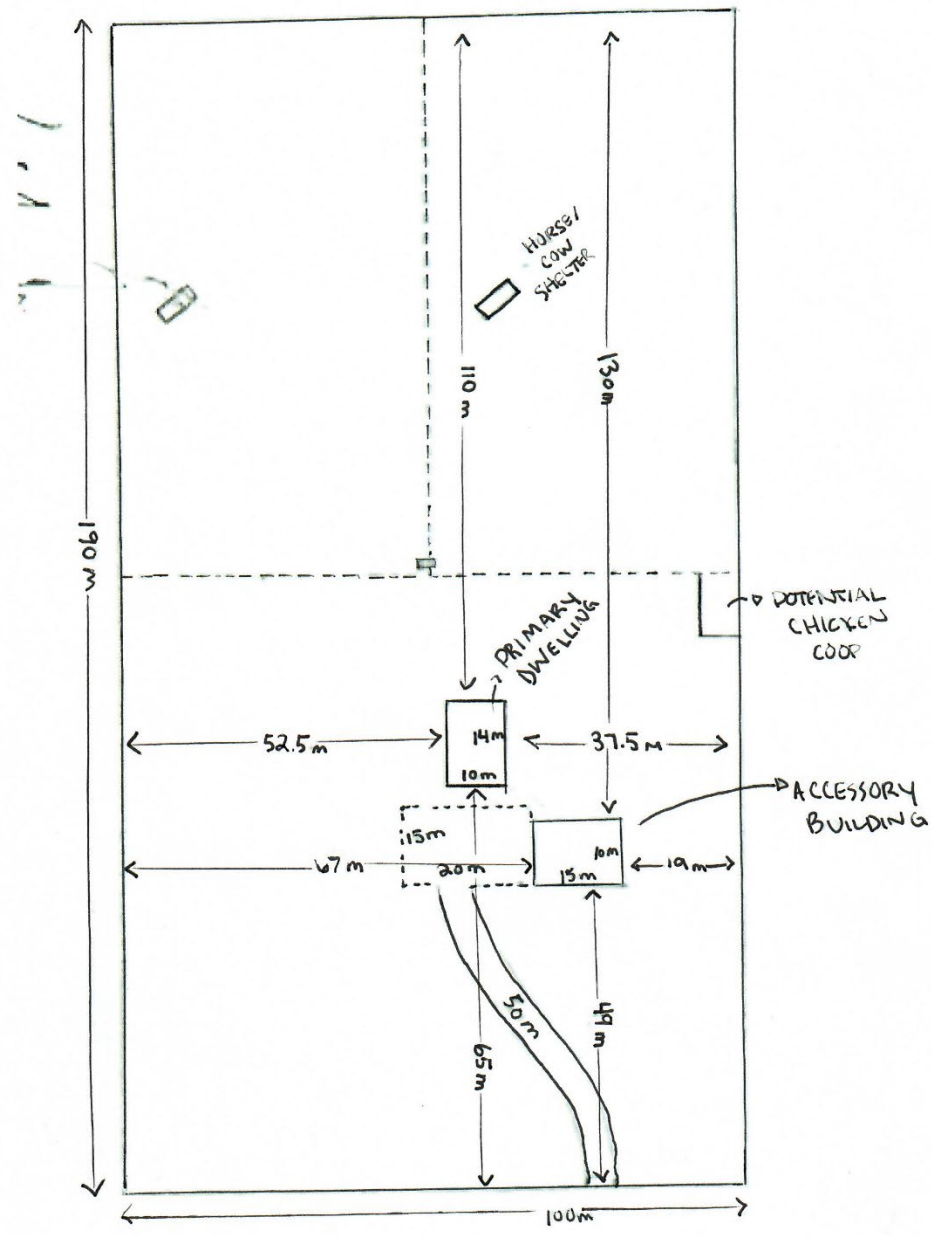

LOT # 1

SCALE 1:1000

Ortho



5/7/2026, 1:35:09 PM

- Residences
- Road Network
- County Gravel Road
- Hamlet Street
- Railway
- Undeveloped/Gridline/Other
- County Boundary
- Landowners (April 16, 2026)
- Provincial Grazing Leases (March 2026)

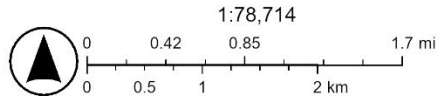

1:78,714

Sources: Esri, TomTom, Garmin, FAO, NOAA, USGS, © OpenStreetMap contributors, and the GIS User Community