



P.O. BOX 180  
VULCAN, ALBERTA  
T0L 2B0

TELEPHONE: 1-403-485-2241  
TOLL FREE: 1-877-485-2299  
FAX: 1-403-485-2920  
www.vulcancounty.ab.ca

April 30, 2026

**Our File: DP 17-2026**

### **Notification of Approved Development**

Vulcan County has approved the following development permit application:

<u>Location:</u>	Division 3; NW 18-17-25 W4
<u>Development:</u>	Ready-to-Move Dwelling
<u>Land Use District:</u>	(RG) – Rural General
<b><u>Applicant:</u></b>	<b>Roland McFadden</b>

If you have any questions or concerns regarding this development, please contact the undersigned via regular mail, fax, email [devassist@vulcancounty.ab.ca](mailto:devassist@vulcancounty.ab.ca), or call 403-485-3135.

As per *Alberta Municipal Government Act [Section 685]* any person claiming to be affected may appeal the decision of the Development Authority. The appeal can be made by writing to the Secretary of the Chinook Intermunicipal Subdivision and Development Appeal Board and must contain the reasons for the appeal. The written appeal, along with the \$600 appeal fee can be mailed to the address at the top of the page or dropped off at the County Office at 102 Centre Street in Vulcan. The appeal period ends on **May 21, 2026**; any appeal must be received by Vulcan County before this deadline.

Kindest regards,

A handwritten signature in blue ink that reads "Alena Matlock".

Alena Matlock  
Development Officer  
Vulcan County



RR260

RR260

RR260

RR260

~ 300 ft

46'  
52'

Proposed new RTM

≥ 150 ft

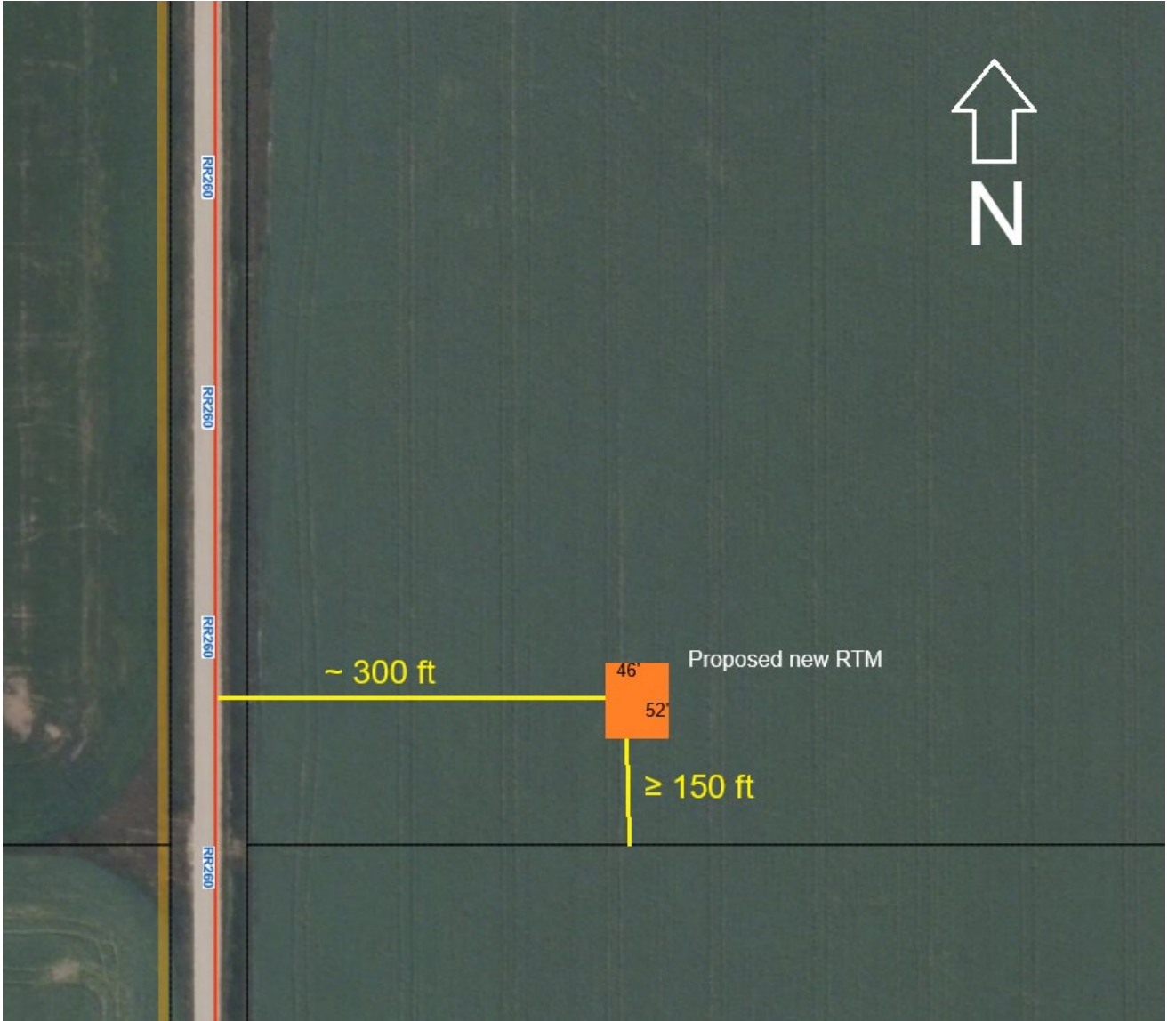

# Ortho



4/15/2026, 1:25:58 PM

- Residences
- Provincial Secondary Highway
- Railway
- County Gravel Road
- County Paved Road
- Hamlet Street
- Undeveloped/Gridline/Other
- County Boundary
- Landowners (April 1, 2026)

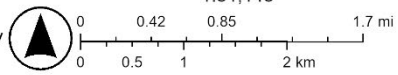

Sources: Esri, TomTom, Garmin, FAO, NOAA, USGS, © OpenStreetMap contributors, and the GIS User Community