



P.O. BOX 180
VULCAN, ALBERTA
T0L 2B0

TELEPHONE: 1-403-485-2241
TOLL FREE: 1-877-485-2299
FAX: 1-403-485-2920
www.vulcancounty.ab.ca

March 18, 2025

Our File: DP 10-2025

Notification of Proposed Development

Vulcan County has received the following development permit application:

<u>Legal Land Location:</u>	Plan 9912215, Lot 1 within NW 33-16-21 W4
<u>Type of Development:</u>	Water Storage Tank (with setback variance)
<u>Land Use District:</u>	(GRR) – Grouped Reservoir Residential
<u>Applicant:</u>	Jason Humphrey

The Municipal Planning Commission will be meeting to consider this application on **April 2, 2025** at 9:00 a.m. in the Vulcan County Administration Building, 102 Centre Street Vulcan, Alberta. You are welcome to attend.

If you have any concerns or comments regarding this development or if you require more information, please contact the Vulcan County office, quoting the above file number by **4:00 pm on March 31, 2025**, to the Development Department via regular mail, fax, email devassist@vulcancounty.ab.ca, or call 403-485-3135. *Please note that your name and comments will be made publicly available in the Council or MPC agenda. Your email address or mailing address will not be included in the public record. This information is collected under the authority of Vulcan County's Procedural Bylaw 2021-036 and Section 33(c) of the Freedom of Information and Protection of Privacy Act. If you have any questions about the collection or use of your personal information, contact the FOIP Coordinator at 403-485-3102.*

Kindest regards,

A handwritten signature in blue ink that reads 'Alena Matlock'.

Alena Matlock
Development Officer
Vulcan County

LOT #1
NW-33-16-21-4

N

smaller Garden shed removed

DP 10-2025 for
the potable water
tank

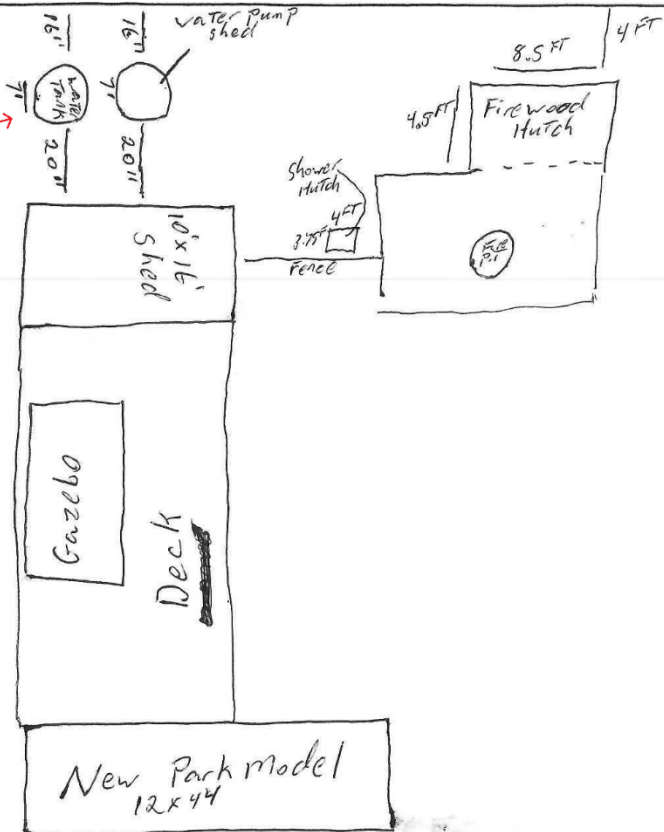

Ortho



3/3/2025, 9:15:31 AM

- Residences
- Landowners (February 16, 2025)
- Road Network
 - County Gravel Road VC Aerial - July 2024
 - County Gravel Road
 - <all other values>
 - County Boundary
- Provincial Grazing Leases (December 2022)
- Red: Band_1
- Green: Band_2
- Blue: Band_3

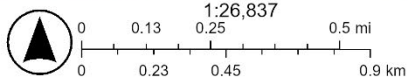

Sources: Esri, TomTom, Garmin, FAO, NOAA, USGS, © OpenStreetMap contributors, and the GIS User Community