



P.O. BOX 180  
VULCAN, ALBERTA  
T0L 2B0

TELEPHONE: 1-403-485-2241  
TOLL FREE: 1-877-485-2299  
FAX: 1-403-485-2920  
[www.vulcancounty.ab.ca](http://www.vulcancounty.ab.ca)

September 20, 2024

**Our File: DP 91-2024**

### **Notification of Proposed Development**

Vulcan County has received a development permit application:

**Legal Land Location:** NW 26-17-23 W4  
**Type of Development:** Temporary Dwellings  
**Land Use District:** (RG) – Rural General  
**Applicant:** **Mialta Hutterian Brethren**

The Municipal Planning Commission will be meeting to consider this application on **October 2, 2024** at 9:00 a.m. in the Vulcan County Administration Building, 102 Centre Street Vulcan, Alberta.

If you have any concerns or comments regarding this development or if you require more information, please contact the Vulcan County office, quoting the above file number by **4:00 pm on September 30, 2024**, to the Development Department via regular mail, fax, email [devassist@vulcancounty.ab.ca](mailto:devassist@vulcancounty.ab.ca), or call 403-485-3135.

Kindest Regards,

A handwritten signature in blue ink that reads "Alena Matlock".

Alena Matlock  
Development Officer  
Vulcan County

Range RD 232



1660'

45'

# Ortho

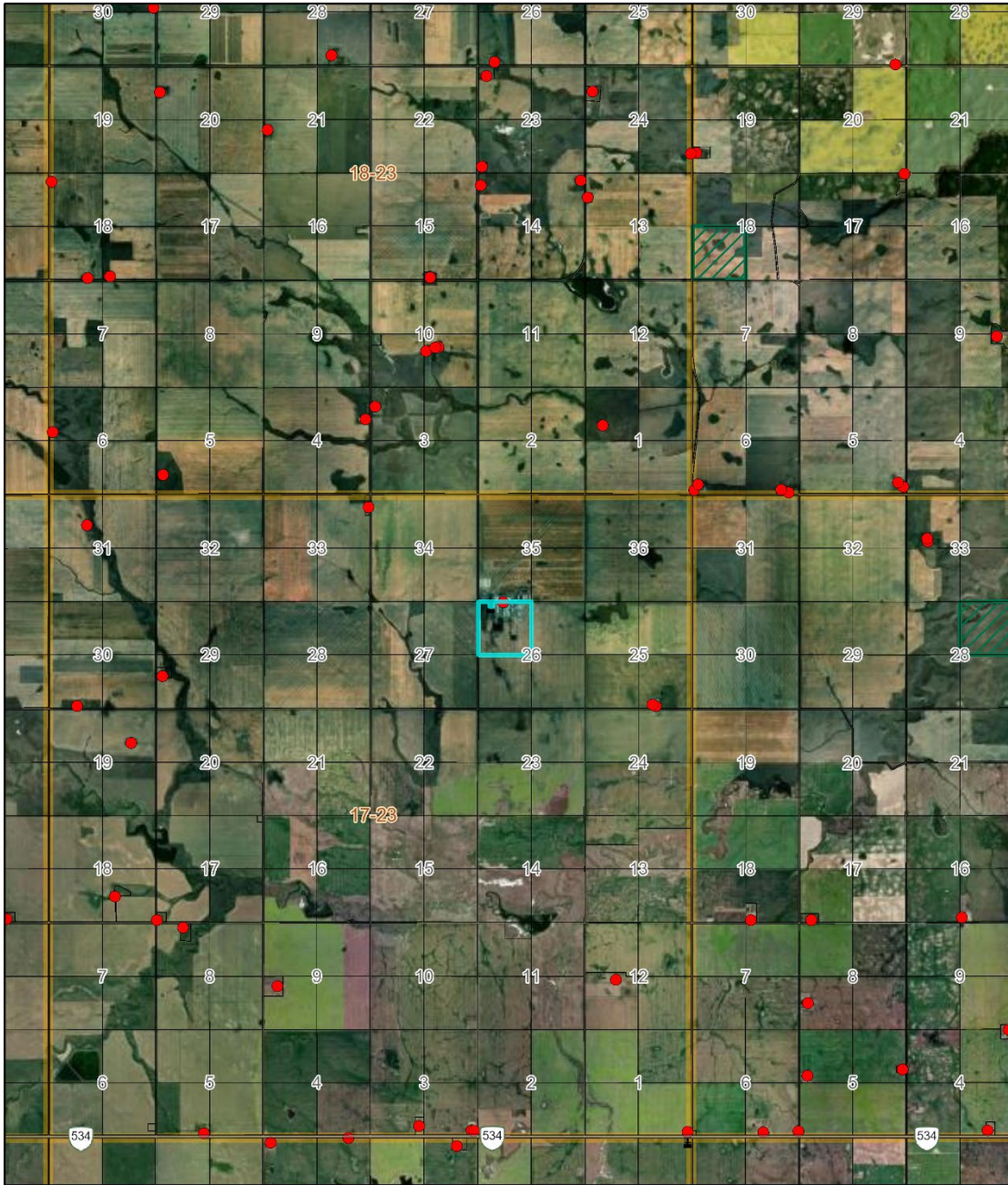

9/20/2024, 1:00:48 PM

- Residences
- Points of Interest
  - ⚰ Cemetery
  - ⚰ Cemetery
  - 🏛️ Community Hall
  - Landowners (August 16, 2024)
  - ▨ Provincial Grazing Leases (December 2022)

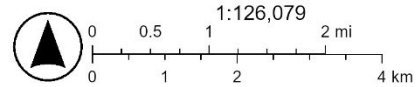

Esri Canada, Esri, TomTom, Garmin, SafeGraph, GeoTechnologies, Inc, METI/NASA, USGS, EPA, USDA, NRCan, Parks Canada, Earthstar Geographics

