



P.O. BOX 180  
VULCAN, ALBERTA  
T0L 2B0

TELEPHONE: 1-403-485-2241  
TOLL FREE: 1-877-485-2299  
FAX: 1-403-485-2920  
www.vulcancounty.ab.ca

April 26, 2024

**Our File: DP 36-2024**

### **Notification of Approved Development**

Vulcan County has approved the following development permit application:

Legal Land Location: SE 15-15-19 W4  
Type of Development: Renewable Energy; Individual  
Land Use District: (RG) – Rural General  
**Applicant: David & Shirley Wiens**

If you have any questions or concerns regarding this development, please contact the undersigned via regular mail, fax, email [devassist@vulcancounty.ab.ca](mailto:devassist@vulcancounty.ab.ca), or call 403-485-3135.

As per *Alberta Municipal Government Act [Section 685]* you are eligible to appeal the decision of the Development Authority. Vulcan County has determined that appeal jurisdiction remains at the local level for this Development Permit. The appeal can therefore be made in writing to the Secretary of the Chinook Intermunicipal Subdivision and Development Appeal Board and must contain the reasons for your appeal. The written appeal, along with the \$600 appeal fee can be mailed to the address at the top of the page or dropped off at the County Office at 102 Centre Street in Vulcan. The appeal period ends on **May 17, 2024**, any appeal must be received by the Vulcan County before this deadline.

Kindest regards,

A handwritten signature in blue ink that reads "Alena Matlock".

Alena Matlock  
Development Officer  
Vulcan County

**Wiens Family Farms - Site 3: SE-15-15-19-W4**  
**61.6 KW DC / 44 KW AC**



**System Dimensions:**  
**123 ft x 28 ft**

2,000ft

Yard site with house,  
outbuildings, bins,  
corrals

Solar Array

Site 3: SE-15-15-19

Meter

1,400ft

450ft

1,000ft

Township Rd #152

Image S. Alberta MD 31's and Counties  
Image © 2024 CNES / Airbus

# 36-2024 Ortho

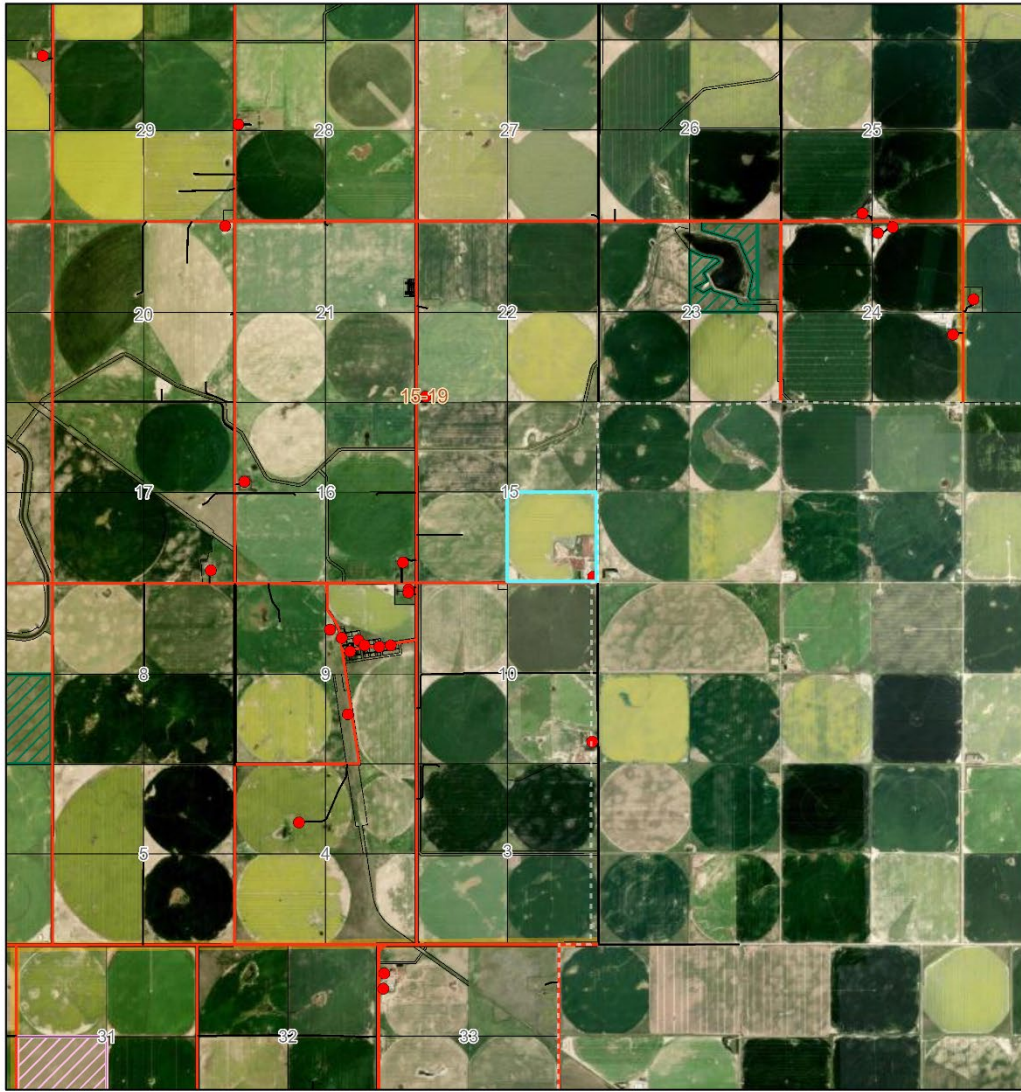

4/25/2024, 11:18:02 AM

- Residences
- County Gravel Road
- Hamlet Street
- ⊕ Cemetery
- Landowners (April 1, 2024)
- County Gravel Road
- Provincial Grazing Leases (December 2022)
- County Gravel Road
- Vulcan County Grazing Leases (December 2022)

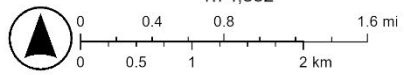

Esri Canada, Esri, TomTom, Garmin, SafeGraph, GeoTechnologies, Inc, METI/NASA, USGS, EPA, USDA, NRCan, Parks Canada, Earthstar Geographics